

**4490**



**4490 Folding table**

Uncluttered design, easy-to-operate and convenient to store: this folding table serves as the perfect partner for a wide range of applications and environments.

## Frame

T-base frame, columns made from Ø 40 x 2 mm tubular metal, feet stabilizers from 40 x 2 mm tubular metal, plastic-sleeve gliders with integrated adjustment screws. The foldable sections are screw-fastened to the table top via a horizontal bar. Ø 30 mm stack protection tubes with caps, powder-coated like the frame. The fittings of the folding mechanism are fully screw-fastened to the table top. Mechanism can be locked through an angled wire bracket that is suspended in a (patented) smooth-running plastic rail, push-button operation.

## Frame surfaces

Standard version: powder-coated in black, optionally powder-coated according to the BRUNE® collection. Thickness of chrome plating: nickel gloss 20-23 my, chromium 0.3 my.

## Table tops

**Plate C:** 30 mm thick, high-quality multi-layer plywood plate E1, top surface optionally covered with HPL plastic or wood veneer according to the BRUNE® collection. Lower surface white HPL or beech veneer. Straight edge, 2 mm thick, in material to match table top (plastic for plastic, veneer for veneer).

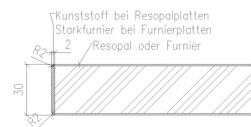

**Plate D:** 30 mm thick, 28 mm thick high-quality multi-layer plywood plate E1, top surface optionally covered with HPL plastic or wood veneer according to the BRUNE® collection. Lower surface white HPL or beech veneer. Edge with solid beechwood edge band, smooth finish, 9 mm thick.

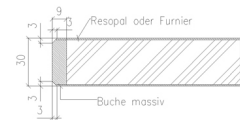

**Plate E:** 30 mm thick, 28 mm high-quality multi-layer plywood board E1, coated in high-pressure laminate (HPL) or veneer according to the BRUNE® collection. Lower surface: white HPL or beech veneer. Edge: solid beech edge band, crowned, 9 mm thick.

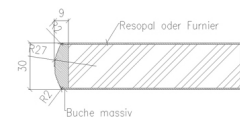

**Plate O:** 30 mm thick, high-quality multi-layer plywood plate E1, top surface HPL plastic according to the BRUNE® collection. Lower surface white HPL. Edge: black plastic, crowned.

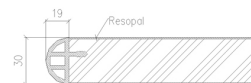

**Plate H:** 20 mm thick, high-quality multilayer plywood plate E1, top surface covered with HPL according to the BRUNE® collection. Lower surface white HPL. Edge with solid beechwood edge band, smooth finish, 65 mm high, galvanized corners, 15 mm thick.

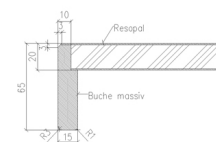

**Alternative option:** Plates C, D + E can also be delivered with a lightweight board made from poplar plywood (replacing the E1 board).

## Veneer finish

---

Wooden elements made from beech wood, with natural varnish (low-solvent water varnish) in the standard version. Optionally stained according to the BRUNE® collection.

## HPL surfaces

---

Resopal®-HPL from the BRUNE® collection.

## Gliders

---

Plastic gliders with integrated height-adjustment screws.

## Dimensions

---

Table height: 75 cm

Table size:           min.   60 cm  
                          max.   180 cm

|          |              |       |
|----------|--------------|-------|
| Weights: | 120x60 cm    | 22 kg |
|          | 140x60 cm    | 24 kg |
|          | 160x60 cm    | 27 kg |
|          | 120x70 cm    | 24 kg |
|          | 140x70 cm    | 27 kg |
|          | 160x70 cm    | 30 kg |
|          | 120x80 cm    | 27 kg |
|          | 140x80 cm    | 30 kg |
|          | 160x80 cm    | 33 kg |
|          | trapez       |       |
|          | 140x70x61 cm | 20 kg |
|          | 160x80x69 cm | 24 kg |

## Certificates

---



TÜV Certificate  
ID 1111273939

ISO 9001:2015



Quality management in accordance  
with DIN EN ISO 9001

ISO 14001:2015



Environmental management system in  
accordance with DIN EN ISO 14001