

**4412**



**4412 Folding table**

Functionality, robustness and durability are the attributes that distinguish this folding table. The model is very easy-to-handle: rather than having to follow a complex set of instructions, staff can simply proceed intuitively.

## Frame

4-foot frame, foldable, made from Ø 30 x 2 mm tubular metal, fully welded, Ø 10 mm riveted wire brackets, no play in the suspension. The foldable sides are suspended in galvanized steel clips. Transversal bars made from Ø 30 x 2 mm tubular metal, two foldable welded stacking devices from Ø 30 x 2 mm tubular metal, with white caps to protect the tables from damage. Mechanism can be locked through an angled wire bracket that is suspended in a (patented) smooth-running plastic rail, push-button operation.

## Frame surfaces

Standard version: power-coated in black, optionally powder-coated according to the BRUNE® collection or chrome-plated. Chrome-plating structure: nickel gloss 24 my, chromium 5 - 8 my.

## Table tops

**Plate C:** 30 mm thick, high-quality multi-layer plywood plate E1, top surface optionally covered with HPL plastic or wood veneer according to the BRUNE® collection. Lower surface white HPL or beech veneer. Straight edge, 2 mm thick, in material to match table top (plastic for plastic, veneer for veneer).

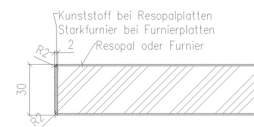

**Plate D:** 30 mm thick, 28 mm thick high-quality multi-layer plywood plate E1, top surface optionally covered with HPL plastic or wood veneer according to the BRUNE® collection. Lower surface white HPL or beech veneer. Edge with solid beechwood edge band, smooth finish, 9 mm thick.

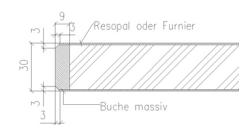

**Plate E:** 30 mm thick, 28 mm high-quality multi-layer plywood board E1, coated in high-pressure laminate (HPL) or veneer according to the BRUNE® collection. Lower surface: white HPL or beech veneer. Edge: solid beech edge band, crowned, 9 mm thick.

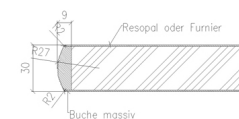

**Plate H:** 20 mm thick, high-quality multilayer plywood plate E1, top surface covered with HPL according to the BRUNE® collection. Lower surface white HPL. Edge with solid beechwood edge band, smooth finish, 65 mm high, galvanized corners, 15 mm thick.

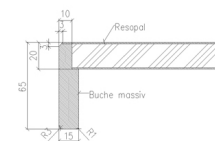

**Alternative option:** Plates C, D + E can also be delivered with a lightweight board made from poplar plywood (replacing the E1 board).

## Veneer finish

Real wood veneer from the BRUNE® collection comes as a standard varnished with a low solvent content water-based lacquer, optionally stained to the BRUNE® collection.

## HPL surfaces

Resopal®-HPL from the BRUNE® collection.

## Gliders

Standard version: Plastic gliders  
Optionally: plastic height-adjustment screws.

## Dimensions

Table Heights:	75 cm		Plate C + D + E + R ( + 5 mm height adjustment screws)	
	74 cm		Plate H ( + 5 mm height adjustment screws)	
Table sizes:	min.	60 cm		
	max.	180 cm		
Weights:	120x60	23 kg	trapez	
	140x60	25,5 kg	140x70x61	21 kg
	160x60	28 kg	160x80x69	25 kg
	120x70	25,5 kg		
	140x70	28,5 kg		
	160x70	31,5 kg		
	120x80	28 kg		
	140x80	31,5 kg		
	160x80	34,5 kg		

## Certificates



TÜV Certificate

ISO 9001:2015



Quality management in accordance  
with DIN EN ISO 9001

ISO 14001:2015



Environmental management system in  
accordance with DIN EN ISO 14001